

MAXHUB WB05

User Manual

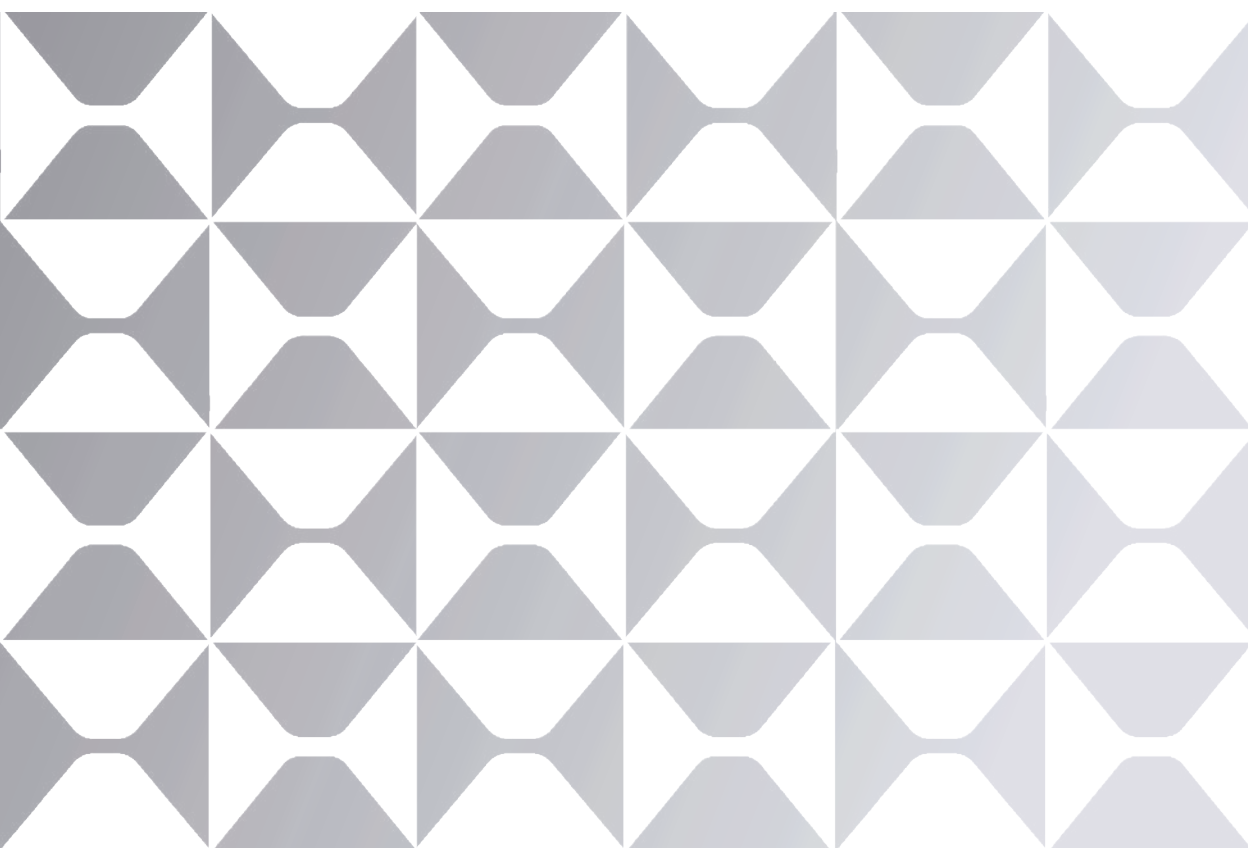

◆ Setup guidance

A. Connect to device hotspot;

1. Connect to the hotspot displayed at the bottom of the screen;

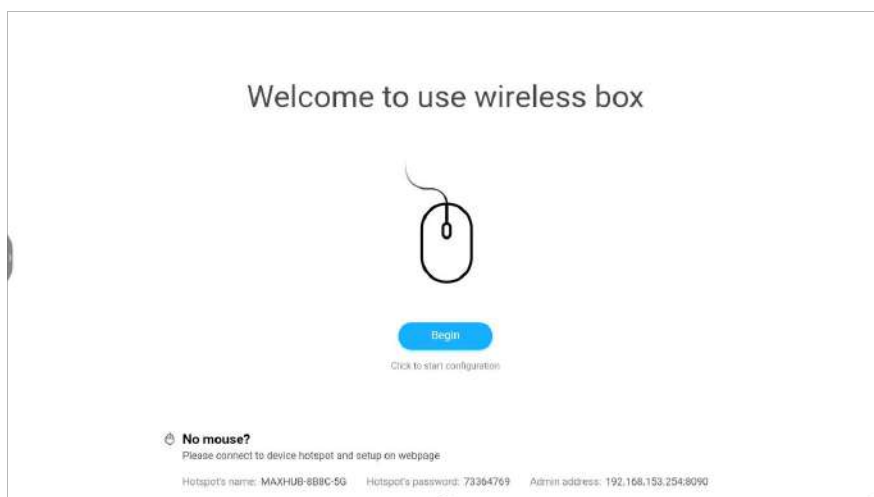

2. Log in to the Admin address;

3. Select a language;

4. Select your location;

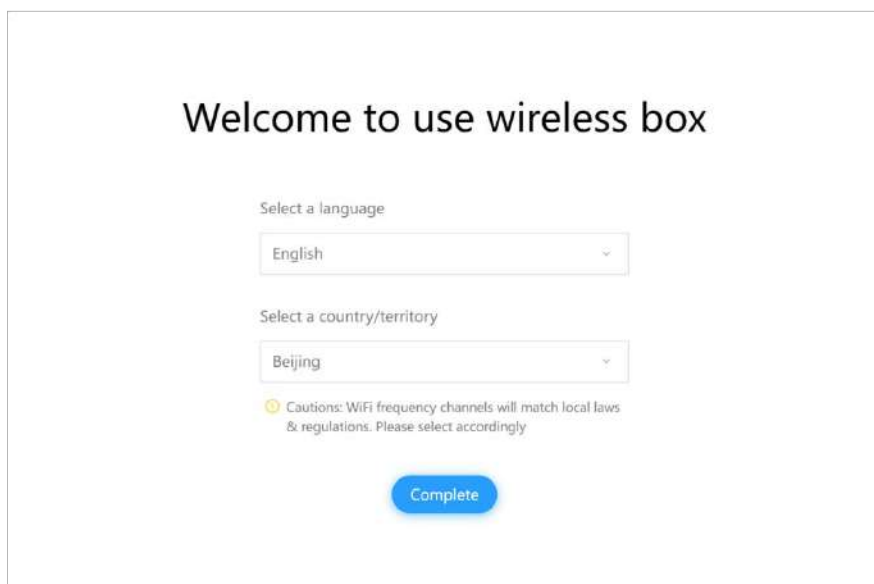

5. After a restart, continuing setting up by clicking “Set up now”;

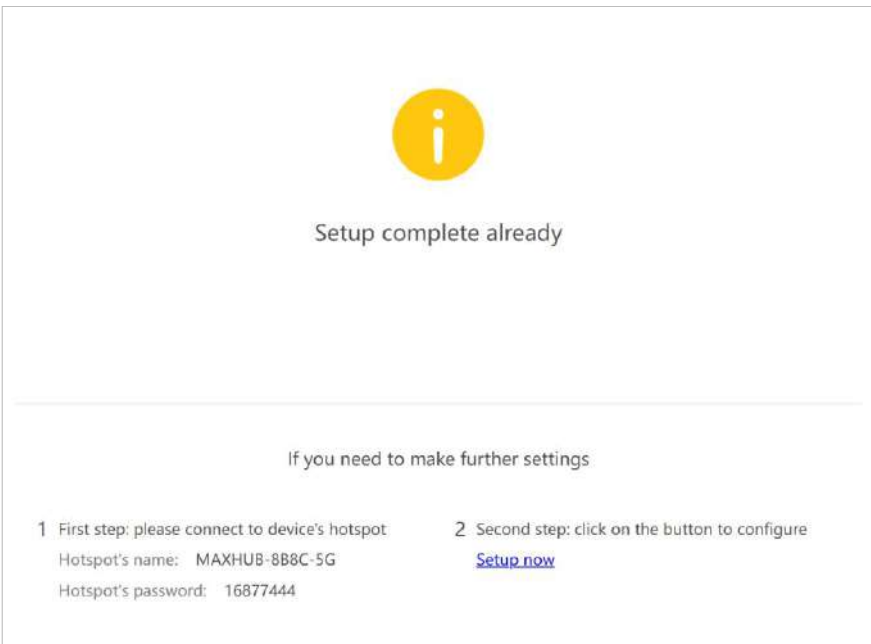

The screenshot shows a web interface with a yellow information icon at the top. Below it, the text "Setup complete already" is displayed. A horizontal line separates this from the next section, which is titled "If you need to make further settings". This section contains two numbered steps: "1 First step: please connect to device's hotspot" and "2 Second step: click on the button to configure". Under step 1, the hotspot name is "MAXHUB-8B8C-5G" and the password is "16877444". Under step 2, there is a blue link labeled "Setup now".

Setup complete already

If you need to make further settings

1 First step: please connect to device's hotspot
Hotspot's name: MAXHUB-8B8C-5G
Hotspot's password: 16877444

2 Second step: click on the button to configure
[Setup now](#)

6. You can set a password when you first log in or choose to skip;

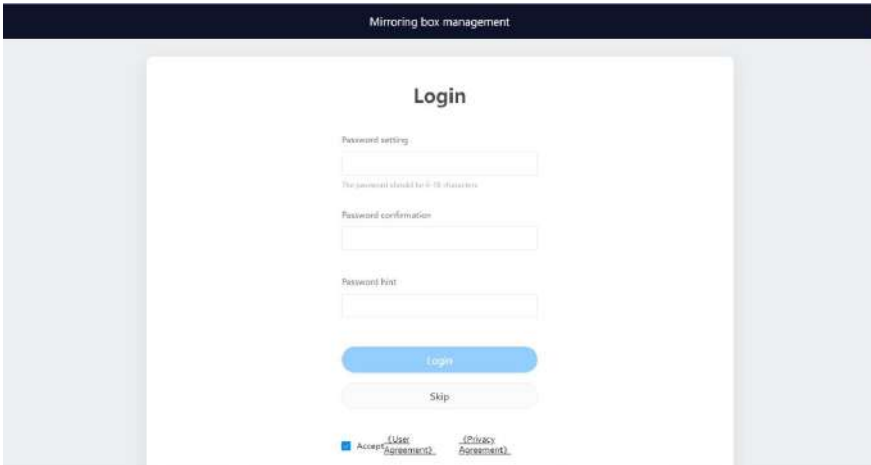

The screenshot shows a web interface titled "Mirroring box management" at the top. The main section is titled "Login". It contains three input fields for "Password setting", "Password confirmation", and "Password hint". Below these fields are two buttons: "Login" (blue) and "Skip" (grey). At the bottom, there are two checkboxes: "Accept" (checked) and "Privacy" (unchecked), with links to "Terms" and "Privacy" respectively.

Mirroring box management

Login

Password setting

The password should be 8-16 characters

Password confirmation

Password hint

Login

Skip

☒ Accept [Terms](#) ☐ Privacy [Privacy](#)

7. Setting up your network or connecting to Wi-Fi;

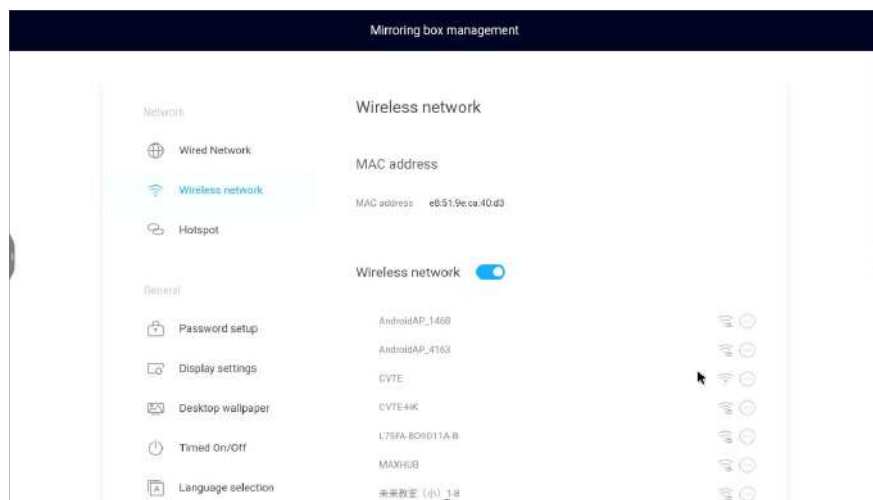

8. Display Settings:

- Set the HDMI output signal to show always or only when screening.
- Select the desired resolution and frame rate.
- Choose the appropriate overscan level.;

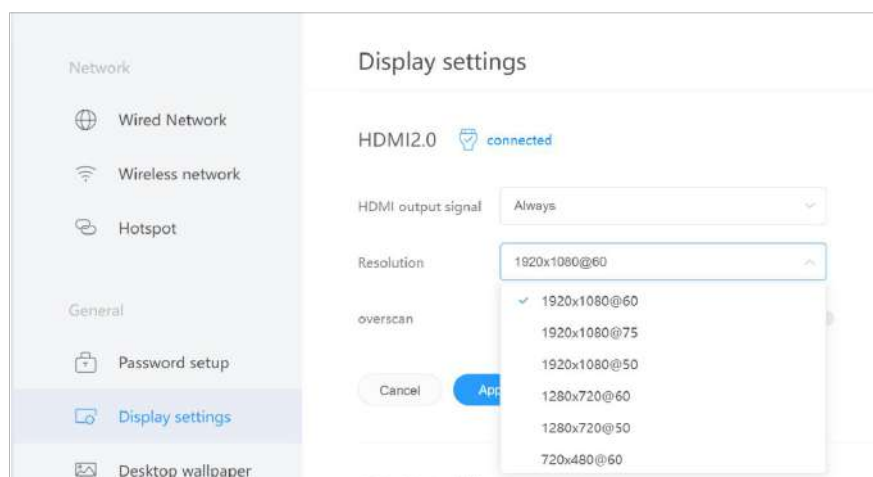
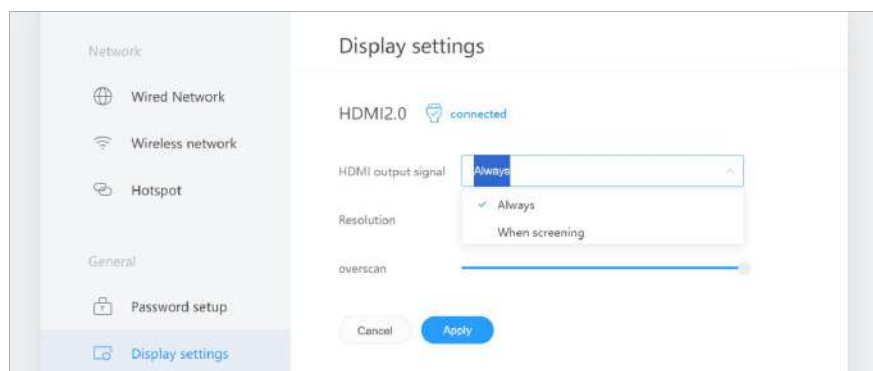

9. Wallpaper Settings:

- Choose whether to display the screen sharing code during screen sharing or not.
- Select either the default image or customize one from your device as wallpaper.
- Decide what guidance you need to show on the wallpaper;

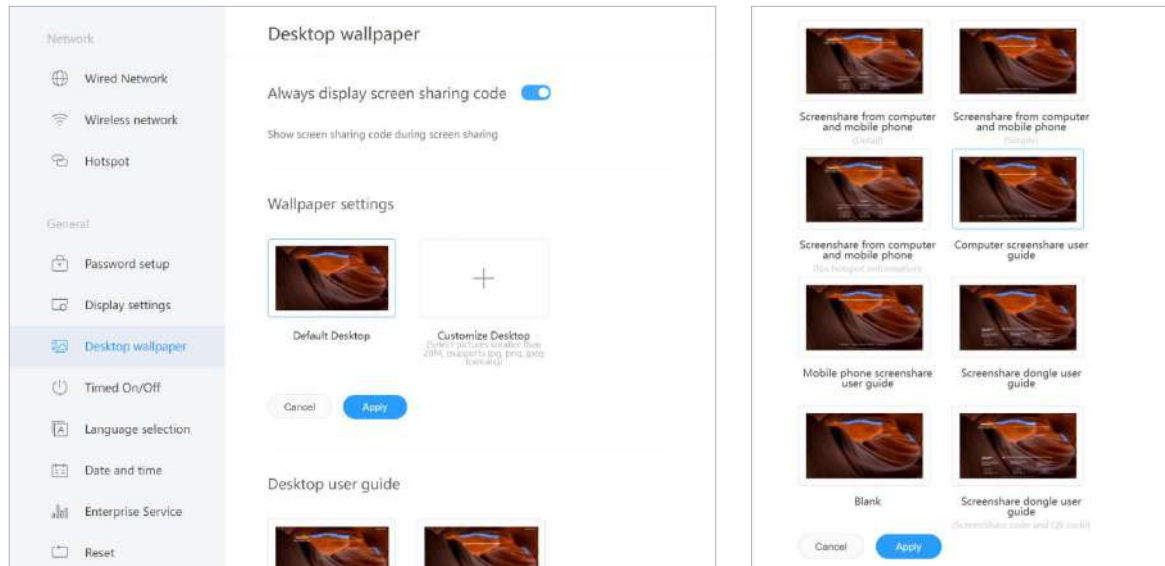

10. Setting the boot and shutdown time and configuring the repetition;

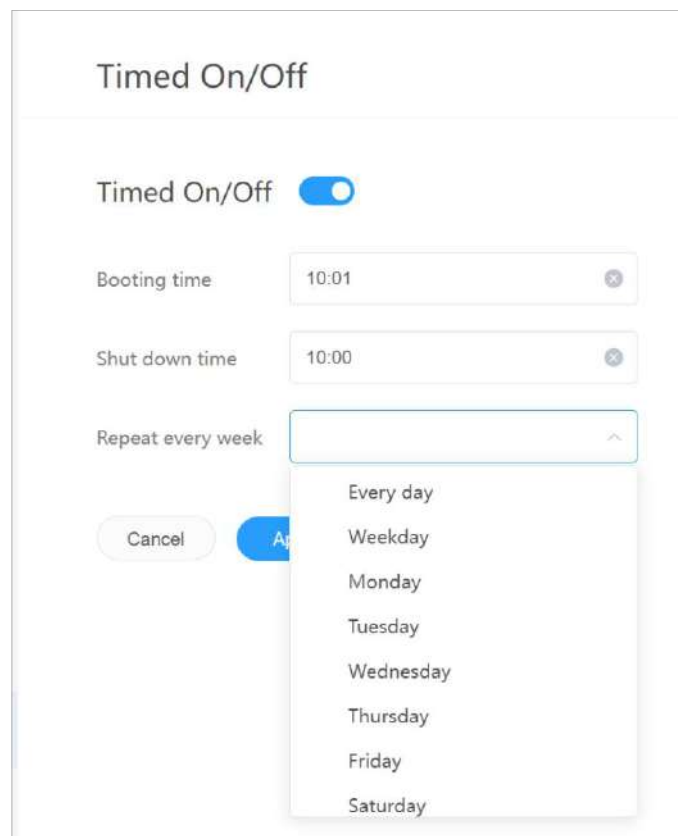

11. To change the language;

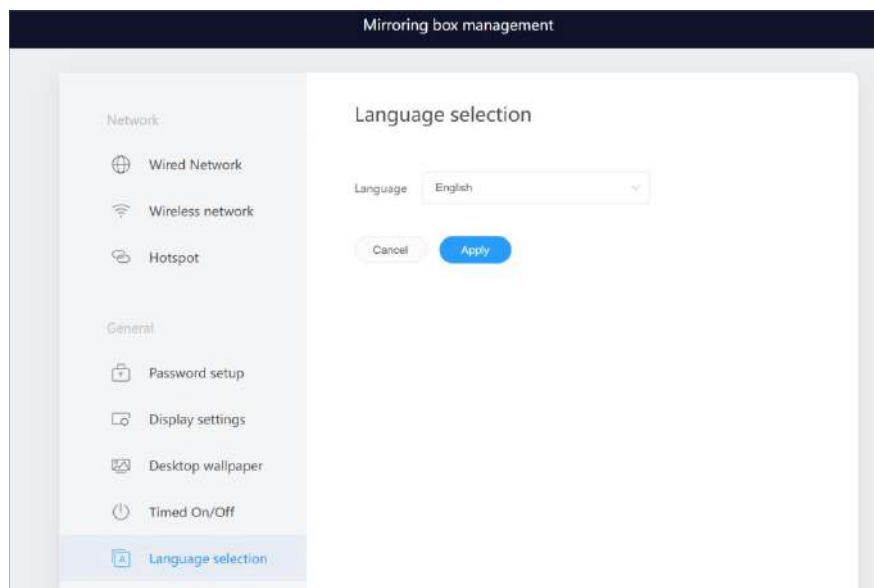

12. To change the date and time or set it for auto-synchronization;

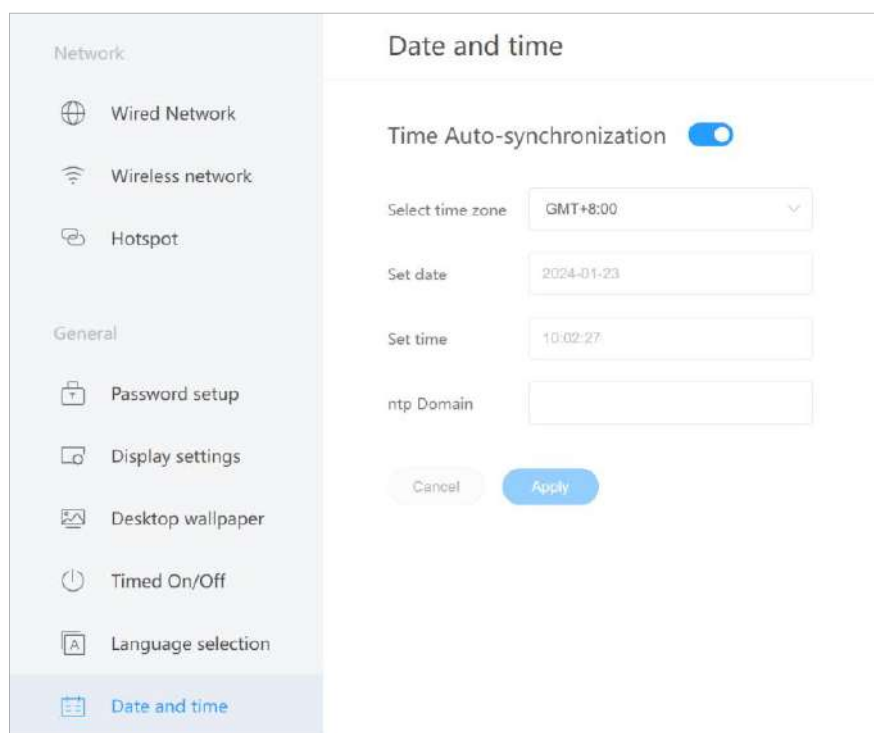

13. To reset the WB05 ;

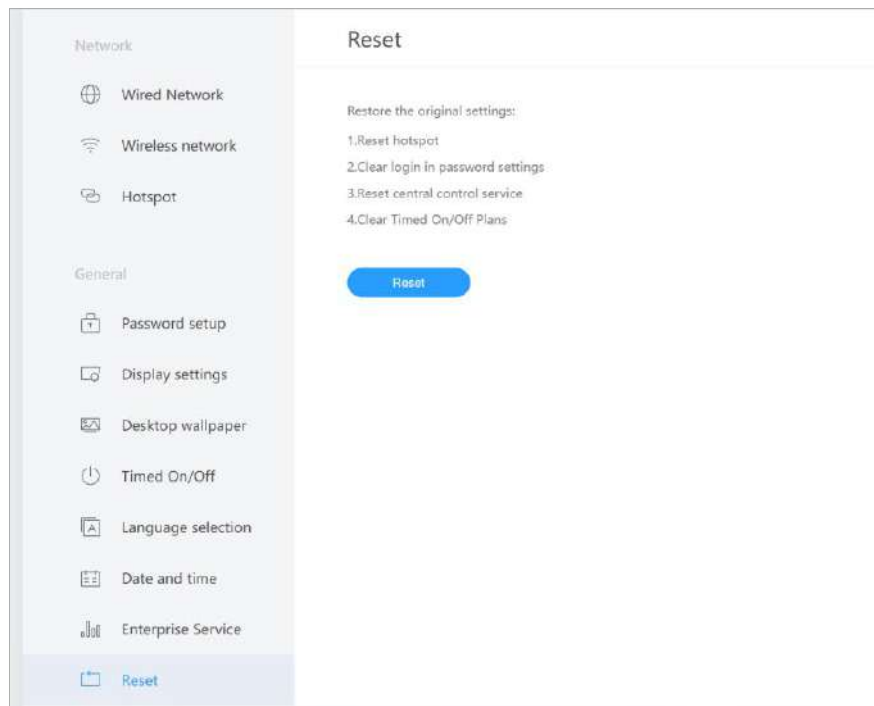

14. To check the firmware version of the WB05 ;

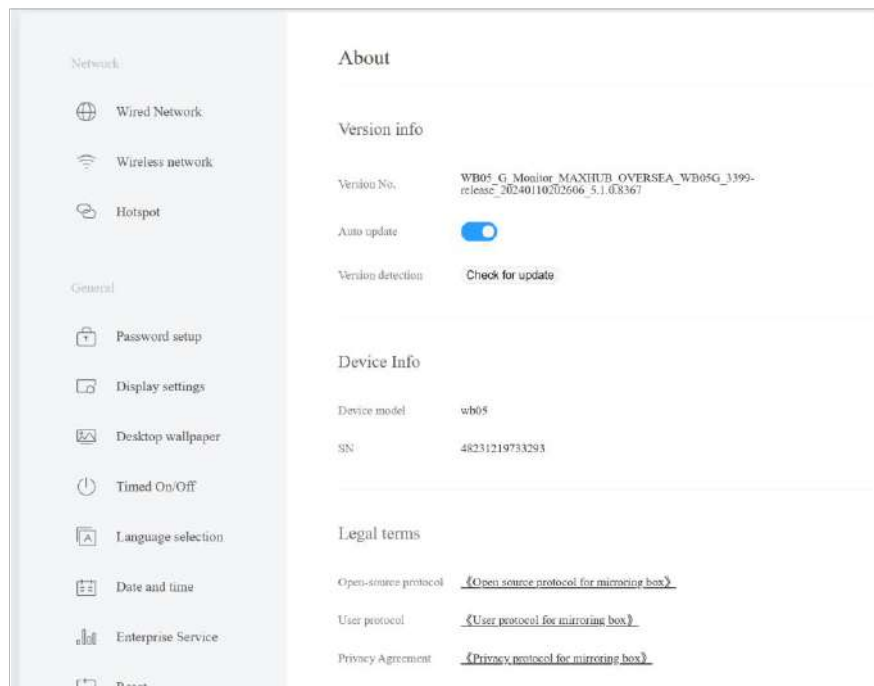

B. Connect to a external Mouse for configuration

1. Clicking Begin;

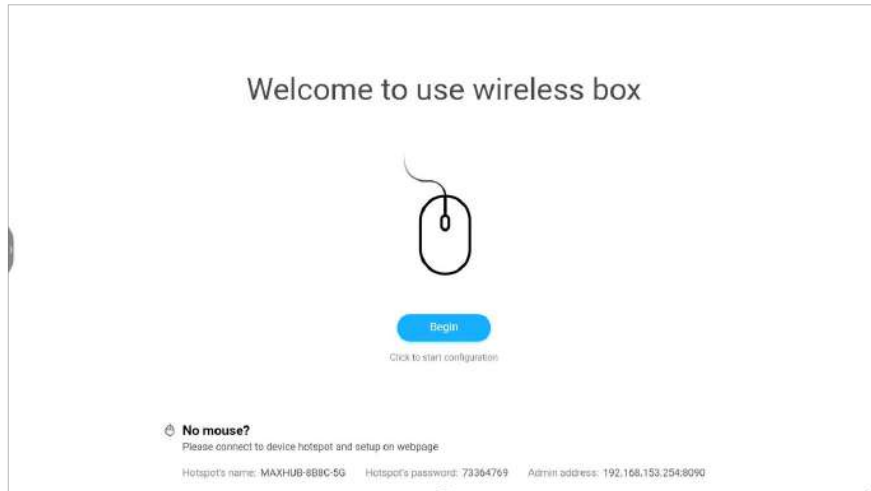

2. Select a language;

3. Select your location and wait for 1-2mins restart

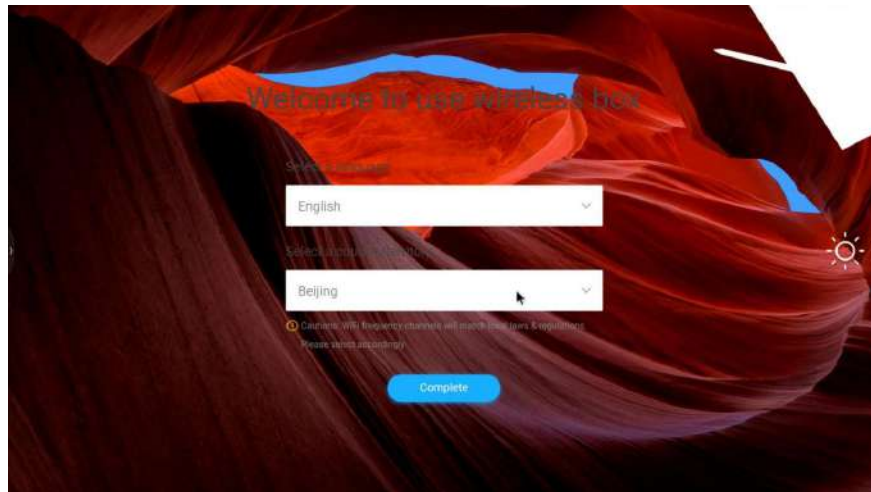

4. Left-Click Top left for 4 times, will enter A)6.)



5. Following A)7-14.)

◆ Screen sharing

A. Computer (MAXHUB Share)

1. Ensure that your computer is connected to the same Wi-Fi network as the WB05 or connected to the Hotspot from the WB05;
2. Launch MAXHUB Share
Could be downloaded from <https://www.maxhub.com/en/support/?#trigger-download-center>
3. Enter the Screen Sharing Code Shown on the Wallpaper

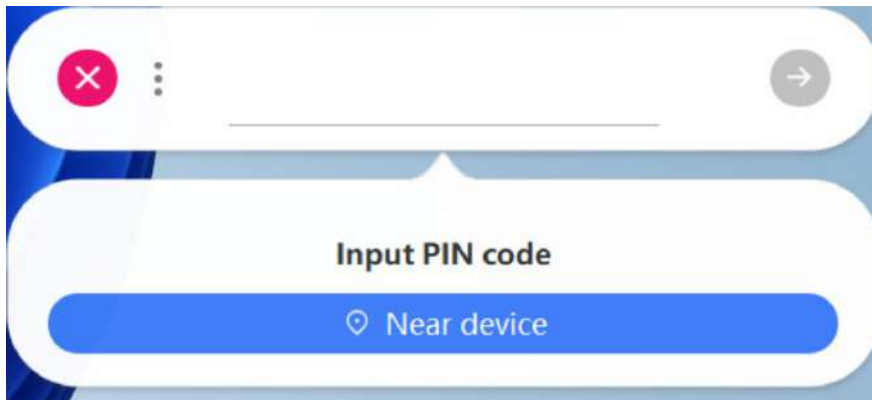

B. Computer(Screen sharing dongle)

1. Pairing the screen sharing dongle with WB05 and plug in to personal Laptop;
2. Push the button of the Screen sharing dongle to sharing screen;



3. If you have multiple device to sharing screen, press and hold the bottom of a Screen sharing dongle to split the screen.

C.Mobile Phone

1. Ensure that your Phone is connected to the same Wi-Fi network as the WB05 or connected to the Hotspot from the WB05;
2. Launch MAXHUB Share on your phone;
3. Input the Code or scan the QR code on the WB05 wallpaper.



◆ BYOM

A. MAXHUB Share



1. Connect to the WB05 by MAXHUB Share software on personal laptop following the previous procedures;
2. Connect the MAXHUB UC products to the WB05 using the USB interface;
3. Turn on and select the MAXHUB Product you want to use on the MAXHUB SHARE of personal laptop

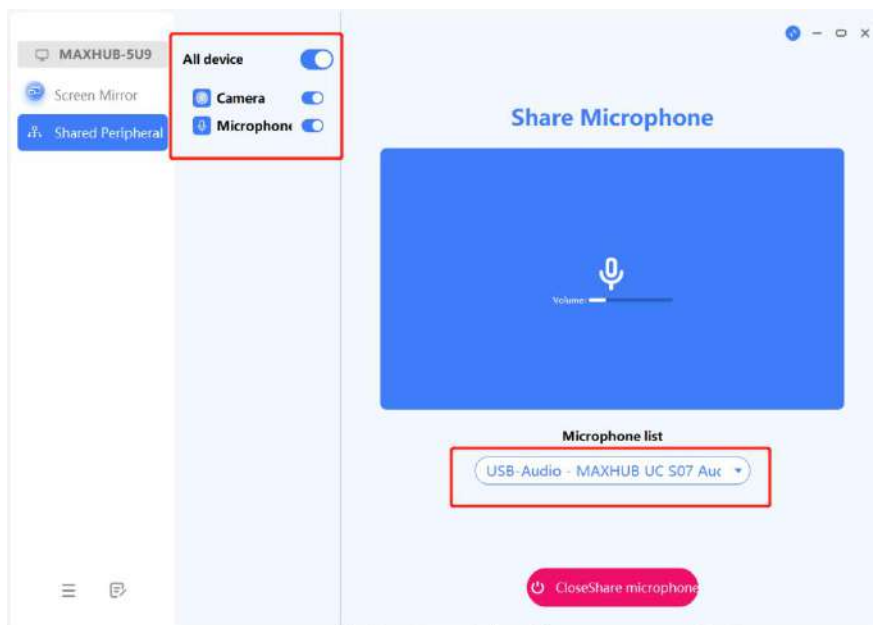

4. Launch a meeting on video meeting platform and select Sharing audio and Sharing camera as audio and video device for wireless use with the MAXHUB UC peripherals

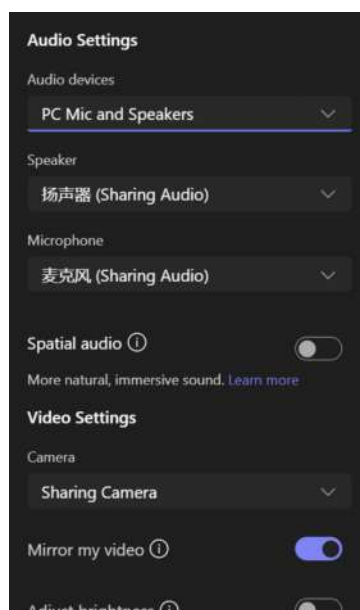

B. WT13M(not available in some zones)

1. Connect the WB05 by screen sharing dongle to the personal Laptop following the previous procedures;
2. Connect the MAXHUB UC products to the WB05 using the USB interface;
3. Launch a meeting on video meeting platform and select M-media as audio and video device for wireless use with the MAXHUB UC peripherals.

